

139.7 mm (5.5 in)
INSIDE

139.7 mm (5.5 in)
INSIDE

ITM. / ART. 1806321

5000L DUAL POWER / RECHARGEABLE FLASHLIGHT

SET-UP



Power Lock
Prevents accidental
Power On
and battery drain.

**POWER LOCK IS ON AT TIME OF
PURCHASE.**

**TURN OFF by holding power button
for three seconds.**

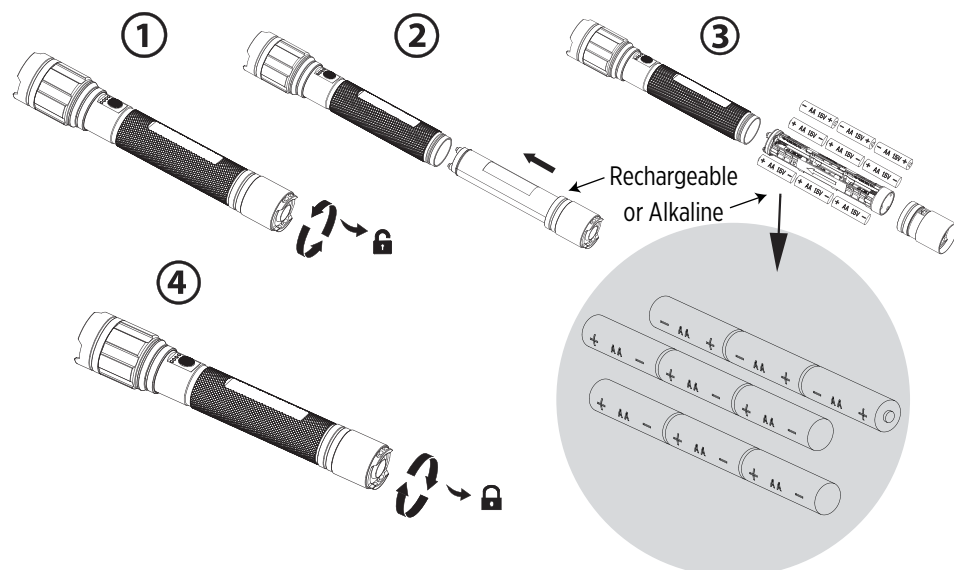
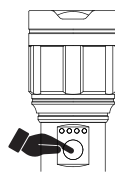

OPERATION

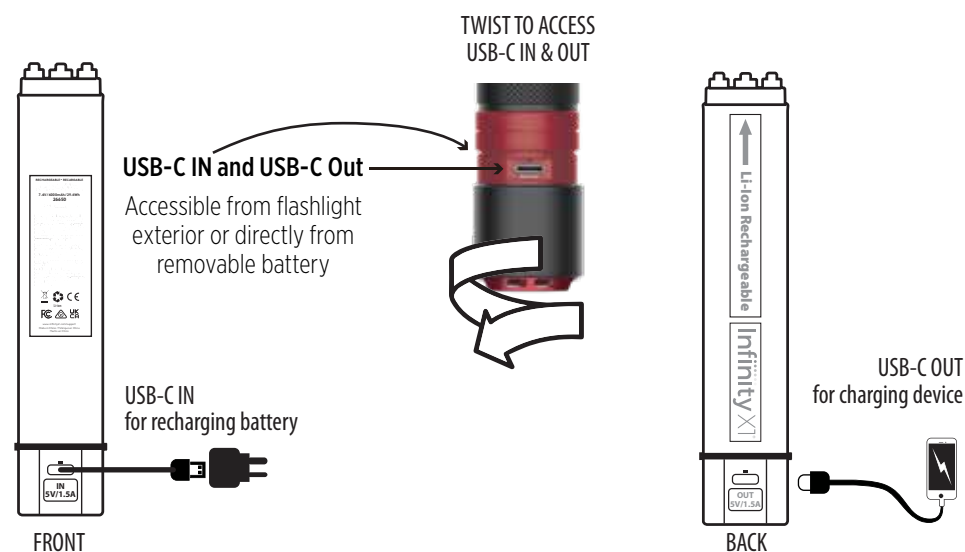
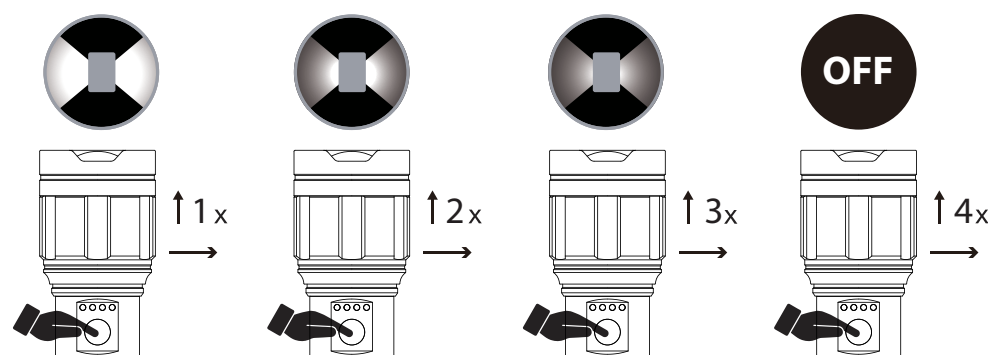

Cable for charging other devices and phone not included

CAUTION

CAUTION: Keep batteries away from children. If swallowed consult a physician at once. Alkaline batteries may explode or leak, and cause burn injury, if recharged, disposed of in fire, mixed with a different battery type, inserted backwards or disassembled. Do not recharge alkaline batteries. Replace all used batteries at the same time. Do not carry batteries loose in your pocket or purse. Do not remove the battery label.

NOTE

WARNING: Changes or modifications not approved by the party responsible for compliance could void user's authority to operate the equipment. This equipment has been tested and found to comply with the limits for a Class B digital device, pursuant to Part 15 of the FCC Rules. These limits are designed to provide reasonable protection against harmful interference in a residential installation. This equipment generates, uses and can radiate radio frequency energy and, if not installed and used in accordance with the instructions, may cause harmful interference to radio communications. However, there is no guarantee that interference will not occur in a particular installation. If this equipment does cause harmful interference to radio or television reception, which can be determined by turning the equipment off and on, the user is encouraged to try to correct the interference by one or more of the following measures:

- Reorient or relocate the receiving antenna.
- Increase the separation between the equipment and receiver.
- Connect the equipment into an outlet on a circuit different from that to which the receiver is connected.
- Consult the dealer or an experienced radio/TV technician for help.

FCC STATEMENT OF COMPLIANCE

Note: This device complies with Part 15 of the FCC Rules. Operation is subject to the following two conditions: (1) This device may not cause harmful interference, and (2) This device must accept any interference received, including interference that may cause undesired operation.

CAN ICES-005 (B) / NMB-005 (B). This Class B digital apparatus complies with Canadian ICES-005.

CAUTION

Always purchase the correct size and grade of battery most suitable for the intended use. Always replace the whole set of batteries at one time, taking care not to mix old and new ones, or batteries of different types. Clean the battery contacts and also those of the device prior to battery installation. Ensure the batteries are installed correctly with regard to polarity (+ and -). Remove batteries from product during periods of non-use. Battery leakage can cause corrosion and damage to this product. Remove used batteries promptly. Keep contacts clean, both on the battery and in the appliance.



Please dispose of batteries according to local regulations for the battery chemistry.
Working Temperature: -20 °C to 54 °C / -4 °F to 129.2 °F.

Compatible with alkaline batteries and rechargeable batteries.
DO NOT mix and use alkaline batteries with rechargeable batteries together.



Heat Safety Lock

Auto off when flashlight lens is covered with some materials.
Heat Safety Lock DOES NOT WORK on some materials and under certain conditions.

Do not cover lens, set flashlight down, or place lens against any surface.

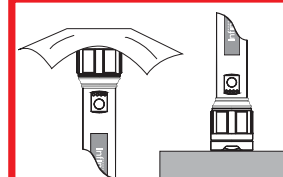

THE LENS OF THE FLASHLIGHT MAY BECOME HOT WHILE IN USE. DO NOT COVER OR TOUCH LENS. DO NOT OPERATE WHILE UNATTENDED. DO NOT PLACE ON ANY SURFACE.

INSIDE